

# The Record of Protected Structures

## Galway City Council

**Unique Identity Number:** 3603

**Address:** Salmon Weir Bridge, Earl's Island.

**Description:** Early C19th Bridge

**Map:** O.S. 3408-02 3408-03 Scale: 1:1000

**National Grid Co-Ordinates:** E129600 N225520

**Special Interest:** Architectural

**Site Features:**

**Section of Map Indicating Structure:** Shaded Green.

© Ordnance Survey Ireland. All rights reserved.

Licence number 2003/07CCMA/Galway City Council.

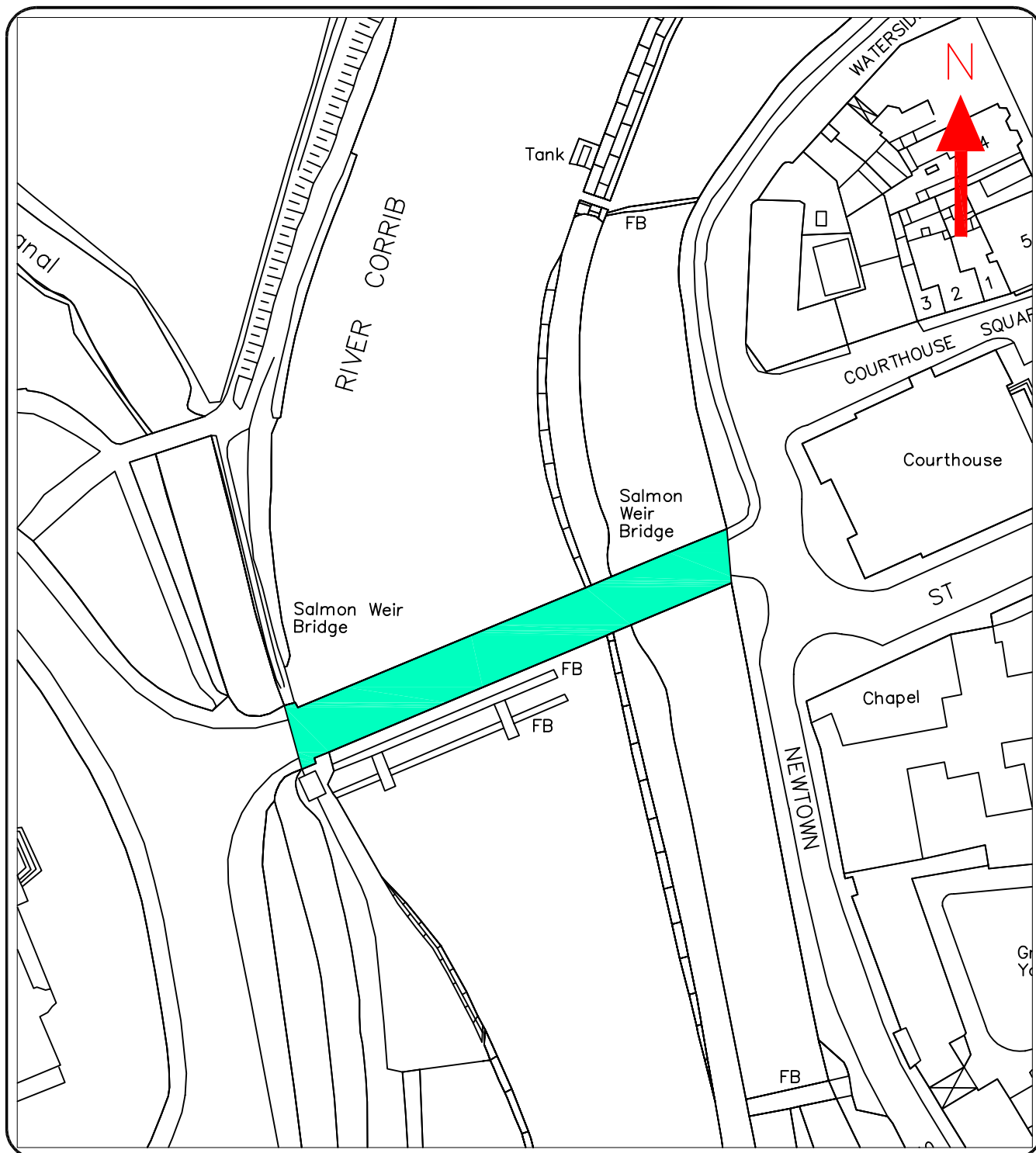

SALMON WEIR BRIDGE, EARL'S ISLAND

